

Baltimore SSO

Site Investigation Report

FM Initials: DF

Project Number: 19 Moore's Run

| | | | | | | | | |
|-----------------------------|-----------------|-----------------|-----------------|--------------|-------------------|--------------------------------|---------------------------------|-----------------------------------|
| Site Name: | 19_MR75I | Monitor Series: | 4000 | Monitor S/N: | 1147 | Manhole #: | MR75 | Investigation Information: |
| Address / Location: | 5600 Todd Ave | Map Page #: | 10 | Map Grid #: | 67EE ₁ | Upstream Input: (L/S, P/S) N/A | | |
| | | Pipe Height: | 30" | Pipe Width: | 30" | Upstream Manhole: MR74 | | |
| | | IP Address: | 166.142.224.165 | | | Downstream Manhole: MR76 | | |
| Access: | Drive | GPS Coords: | N DD.dddd | | W DD.dddd | | Air DOF: 20.5" | |
| | | | 39 20.123 | | 76 32.351 | | Description of Site Hydraulics: | |
| Date/Time of Investigation: | 4/14/2003 14:10 | | | | | | | |

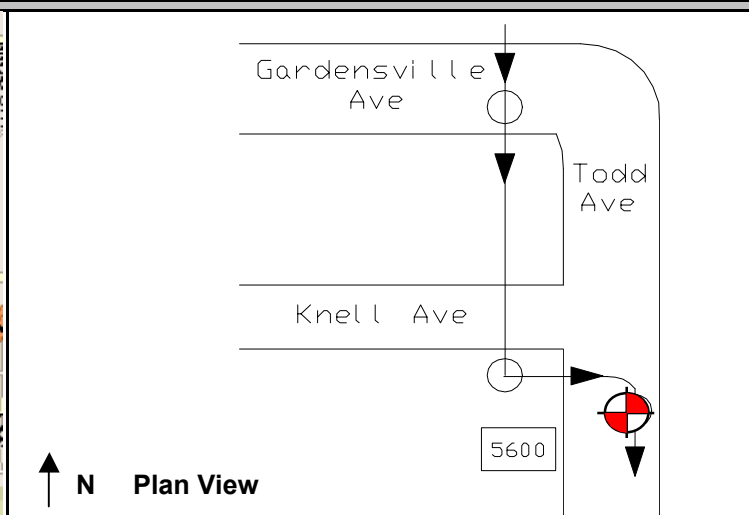
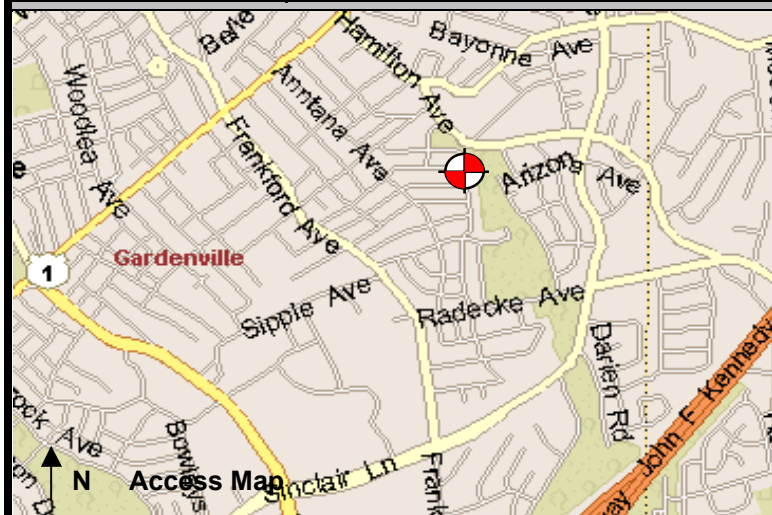

No abnormal flow conditions were observed.

| |
|---|
| Manhole Information: |
| Manhole Depth: 10' |
| Manhole Material / Condition: Brick / Fair |
| Active Drop Connections? No |

| |
|---|
| System Character: |
| <input checked="" type="checkbox"/> Residential |
| <input type="checkbox"/> Commercial |
| <input type="checkbox"/> Industrial |

| |
|----------------|
| Notes: |
| Odd Shape Pipe |

| |
|----------------------|
| Legend: |
| Cast Iron Flap Valve |
| Sensor Location |
| N.T.S.- Not to scale |

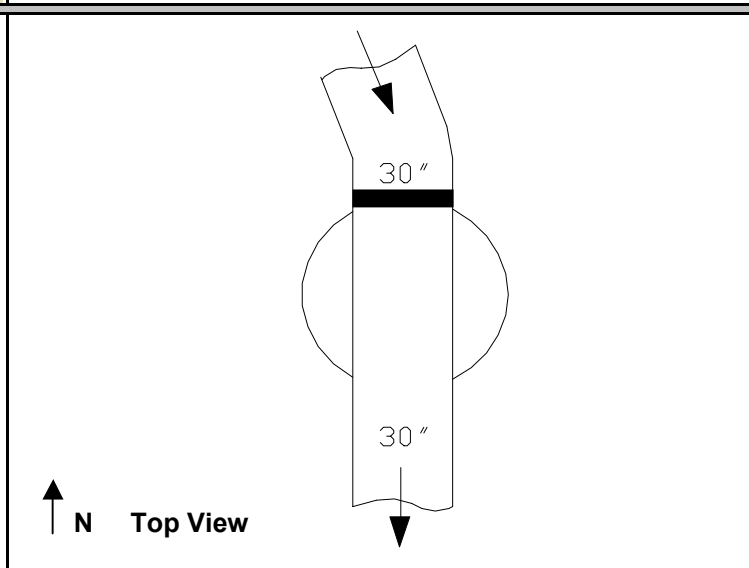
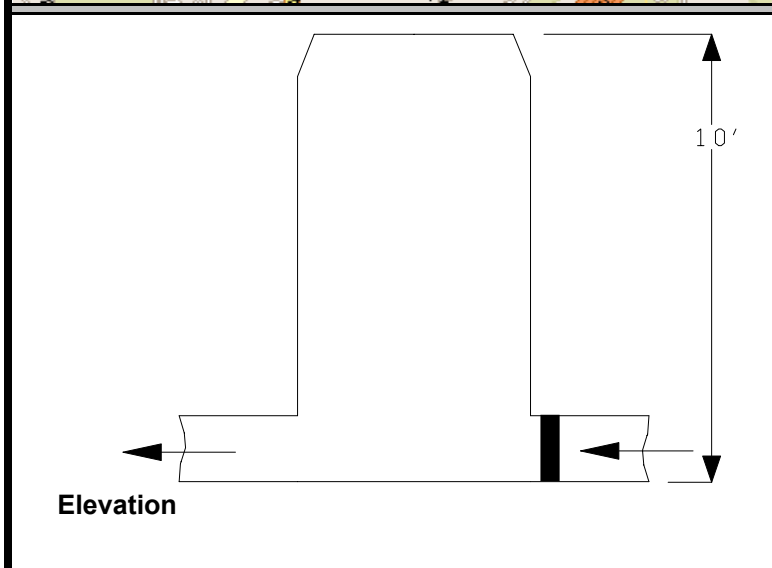

The monitoring period ended as of February 28, 2005.